

BAXI



Luna Duo-tec

SPARE PARTS CATALOGUE

- June 2014 -

HOW TO READ THE SPARE PARTS CATALOGUE

In the spare part catalogue, after the exploded diagrams, there are the components lists of the boilers; this is the meaning of the different columns:

Pos. Identification number of the component in the exploded diagram of the boiler.

Description Short description of the component.

Code BAXI S.p.A. code of the component.

Tab. XX XX is the exploded diagram number of the boiler taken into consideration.

Until 31th December 2011

From serial number Date (year and week) identifying the beginning of production of a component (taken from the serial number of the boiler).

e.g. **B005: year 2000** (B identifies the decade 2000-2009; 0 identifies the year) – **5th week**.

If the box is empty, the component is in use from the beginning of production of the boiler.

To serial number Date (year and week) identifying the end of production of a component (taken from the serial number of the boiler).

e.g. **B012: year 2000** (B identifies the decade 2000-2009; 0 identifies the year) – **12th week**.

If the box is empty, the component is still in use.

Interchangeable It identifies the interchangeability between the new component and the old one.

YES: components are interchangeable.

NO: components are not interchangeable.

FROM 1st January 2102

From serial number Date (year and week) identifying the beginning of production of a component (taken from the serial number of the boiler).

e.g. **1201: year 2012** (1 identifies the decade 2010-2019; 2 identifies the year) – **1th week**.

If the box is empty, the component is in use from the beginning of production of the boiler.

To serial number Date (year and week) identifying the end of production of a component (taken from the serial number of the boiler).

e.g. **1225: year 2012** (1 identifies the decade 2010-2019; 2 identifies the year) – **25th week**.

If the box is empty, the component is still in use.

Interchangeable It identifies the interchangeability between the new component and the old one.

YES: components are interchangeable.

NO: components are not interchangeable.

TABELLA COLLEGAMENTO CODICE CALDAIA - ESPLOSO
TABLEAU CONNECTION CODEX CHAUDIERE - VUE ECLATEE
BOILERS CONNECTION BOARD - EXPLODED VIEW

BOILER CODE	BOILER DESCRIPTION	EXPLODED REF.
CODICE CALDAIA	DESCRIZIONE CALDAIA	RIF. ESPLOSO
CODIGO CALDERA	DESCRIPCION CALDERA	REF. EXPLOSIONADO
CODE CHAUDIÈRE	DESCRIPTION CHAUDIÈRE	RÉF. EXPLOSÉE
710285202/3	LUNA DUO-TEC 1.12 GA	Tab 429
710285302/3	LUNA DUO-TEC 1.24 GA	Tab 429
710568401/2	LUNA DUO-TEC 1.28 GA	Tab 429
710193104	LUNA DUO-TEC 24 GA	Tab 428
710193102/3	LUNA DUO-TEC 24 GA	Tab 428
710193204	LUNA DUO-TEC 28 GA	Tab 428
710193202/3	LUNA DUO-TEC 28 GA	Tab 428
710193304	LUNA DUO-TEC 33 GA	Tab 428
710193302/3	LUNA DUO-TEC 33 GA	Tab 428
710287104	LUNA DUO-TEC 40 GA	Tab 428
710287102/3	LUNA DUO-TEC 40 GA	Tab 428

Luna Duo-tec

04/08/2015

Pos	Code	Description code	710287104 40 GA	710287102/3 40 GA	710193304 33 GA	710193302/3 33 GA	710193304 28 GA	710193302/3 28 GA	710193104 24 GA	710193102/3 24 GA	710568401/2 1.28 GA	710285302/3 1.24 GA	710285302/3 1.12 GA	To serial number	From serial number	Intercha ngeable:
80	711607300	HYDR.INL.GR.WITH OUT BYPASS10L			•											
81	620340	FILTER-TRASDUC GROUP -100078-		•												
81	621090	FILTER TRANSD.RIDUCT.8L ASSEMB					•	•								
81	624410	FILTER ASS.WITH RED.10L-100291			•											
81	711633400	FILTER TRANSD.RIDUCT.8L ASSEMB					•									
81	711633500	FILTER ASS.WITH RED.10L-100291			•											
87	710185800	PUMP CONNECTING ELEMENT WILO					•	•								
87	711652200	PUMP CONNECTING ELEMENT/OR					•	•								
90	620890	FILLING GR.WITH TURBINE 120074					•	•	•	•						
91	5652030	DRAINING TAP	•	•	•	•	•	•	•	•						
92	9951170	SAFETY VALVE 3 BAR	•	•	•	•	•	•								
92	710109400	HYDRAULIC SAFETY VALVE 3 BAR					•	•								
98	5672770	BY-PASS PIPE ASSEMBLY	•	•	•											
99	8380850	FIXING CLIP	•	•	•	•	•	•	•	•						
102	5683540	3 WAY VALVE/MB GROUP LUNA3	•	•	•											
102	5696040	3 WAY VALVE ASS.W.OUT BY-PASS					•	•	•	•				1240		
102	711107400	3 WAY VALVE ASS.W.OUT BY-PASS LUN					•	•	•	•					1241	YES
102	711605800	3 WAY VALVE ASS.						•	•	•						
113	617100	BY-PASS GR.	•	•	•											
119	605760	HYDRAULIC VENTURI ASSEMBLY	•	•	•											
120	600750	SPACER ASSEMBLY	•	•	•											
120	627880	DHW PADDLE GROUP -10.0397-					•	•	•	•				1320		
120	711356900	3 WAY VALVE CARTRIDGE						•	•	•						
120	711356900	3 WAY VALVE CARTRIDGE					•	•	•	•					1321	YES
122	5405370	O-RING					•	•	•	•						
131	8435400	NTC SENSOR					•	•	•	•						
132	5402830	WASHER - SENSOR SEALING					•	•	•	•						
134	710192500	INJECTOR B&P 4,4mm					•	•	•							

Luna Duo-tec

04/08/2015

Pos	Code	Description code	710287104 40 GA	710287102/3 40 GA	710193304 33 GA	710193302/3 33 GA	710193204 28 GA	710193302/3 28 GA	710193104 24 GA	710193102/3 24 GA	710568401/2 1.28 GA	710285302/3 1.24 GA	710285302/3 1.12 GA	To serial number	From serial number	Intercha ngeable:
808	721311400	O-RING 18X2	•		•		•		•							
809	711615000	SPRING	•		•		•		•							
999	8414540	CABLE ROOM TH	•	•	•	•	•	•	•	•	•	•	•			
999	8414620	POWER CABLE	•	•	•	•	•	•	•	•	•	•	•			
999	710062300	CABLE PWM FAN	•	•	•	•	•	•	•	•	•	•	•			
999	710071700	CABLE NTC FLUE	•	•	•	•	•	•	•	•	•	•	•			
999	710079700	CABLE NTC ADDED	•	•	•	•	•	•	•	•	•	•	•			
999	710103100	CABLE GROUND FRAME	•	•	•	•	•	•	•	•	•	•	•			
999	710126600	CABLE EXTERNAL SENSOR BOILER				•	•	•	•	•	•	•	•			
999	710126700	CABLE TERM.BLOCK ROOM THERMOST	•	•	•	•	•	•	•	•	•	•	•			
999	710126800	CABLE SAFETY THERMOSTAT	•	•	•	•	•	•	•	•	•	•	•			
999	710127000	CABLE POWER SUPPLY PCB B&P	•	•	•	•	•	•	•	•	•	•	•			
999	710190300	WIRING HARNESS 3WAY VALVE/PUMP	•	•	•	•	•	•	•	•	•	•	•			
999	710285900	CABLE NTC TANK/EXTERNAL SENSOR	•	•	•											
999	710382300	CABLE REMOTE CONTROL	•	•	•	•	•	•	•	•	•	•	•			
999	710428900	CABLE LOW POWER SUPP.ONLY HEAT	•	•	•											
999	710512100	WIRING HARNESS GAS VALVE B&P	•	•	•	•	•	•	•	•	•	•	•			
999	710514400	WIRING HARNESS LOW VOLTAGE				•	•	•	•	•	•	•	•			

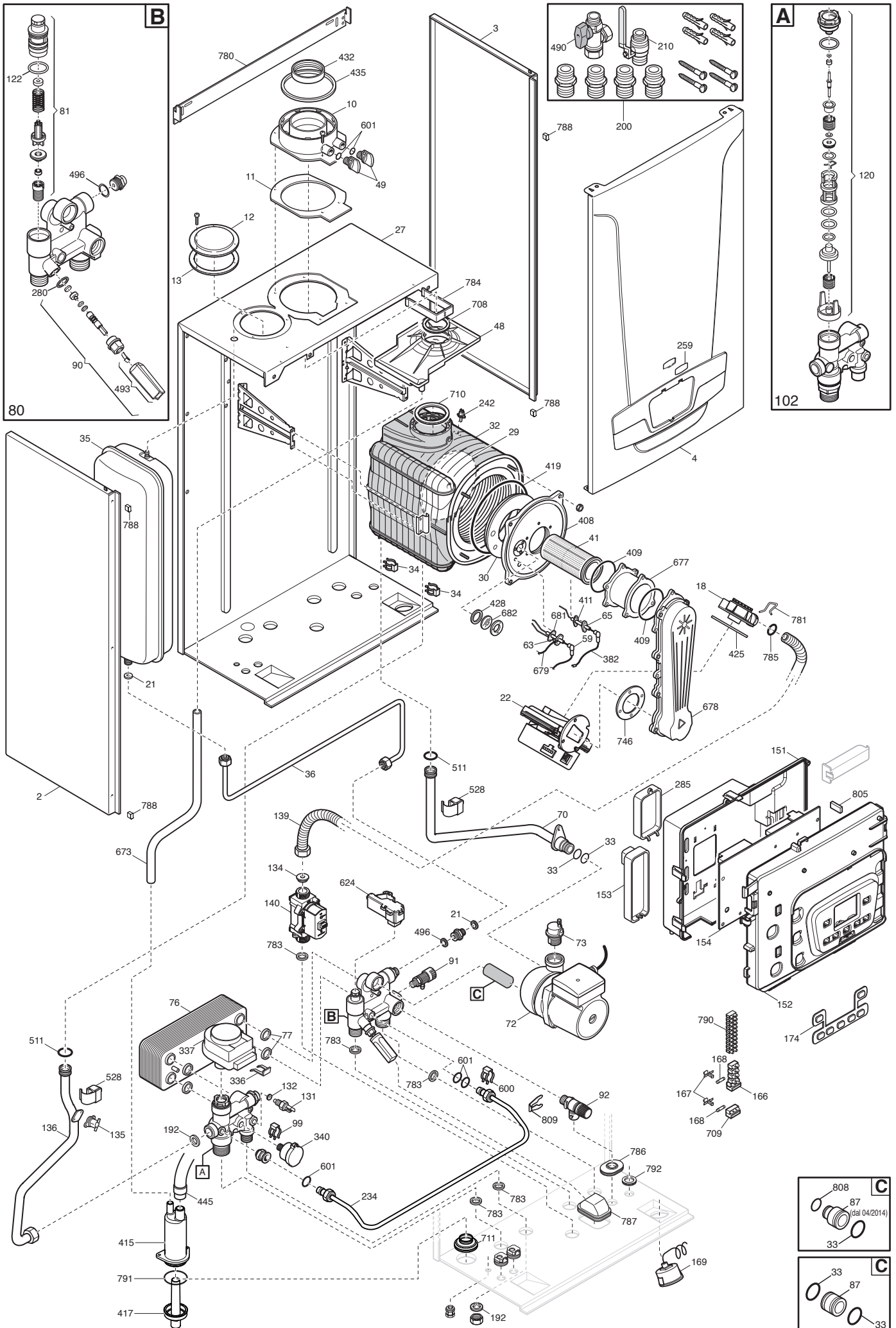

BAXI

BAXI S.p.A.
Via Trozzetti, 20
36061 BASSANO DEL GRAPPA (VI)
ITALY
Tel. +390424517111
Telefax +390424517379
E-mail. service@baxi.it